

METAGLAS®

Metaglas Sight Glass Discs

Type 76

Data sheet VM3.02

Metaglas – the ultimate in sightglass safety:

Metaglas is the strongest and most secure glass for sight window or visual flow indicator applications. The mechanically pre-stressed glass fused to metal construction provides levels of safety and length of service far beyond that offered by any conventional sight glass.

Applications:

As a replacement for conventional sight glasses in the following assemblies:

Circular sight ports to DIN 28121

Plus any other assemblies where the glass is of the same dimensions, e.g. weld neck flanges with flat or raised face.

Advantages:

- Reliability against total failure – the possibility of sudden unexpected rupture is totally excluded.
- High resistance to bending and over-tightening offers simple fast installation with no risk of breakage.
- Extreme resistance to impact, pressure and temperature.
- Reusable in the same or other applications – conventional glass is not.
- Wide acceptance in the European & American chemical industries.

Operating Conditions:

Temperature: -6°C to +300°C

Pressure: Up to 40 bar
Higher pressures possible.

Approvals and Technical Data:

Manufactured and tested in conformance with:

- Directive for pressure equipment 97/23/EG 02/98, Module H/H1 (DIN/EN/ISO 9001)
- AD Standards W0/TRD 100
- Sight glass fused to metal conforming to DIN 7079
- Materials to Vd TÜV specifications and the DIN/EN designated standards.
- Borosilicate glass to DIN 7080

Material Certificates:

Certificate of Conformity to EN 10204-3.1B (or 3.1A at extra cost).

Ring Materials	Operating Temperatures
Carbon Steel (1.0570)	-10°C to 300°C
Duplex Stainless Steel (1.4462)	-30°C to 280°C
Hastelloy C-4 (2.4610)	-60°C to 300°C
Hastelloy C-22 (2.4602)	-60°C to 300°C

Other materials available.



Metaglas sight glass disc.

Dimensions for Metaglas Sight Glass Discs

Type 76

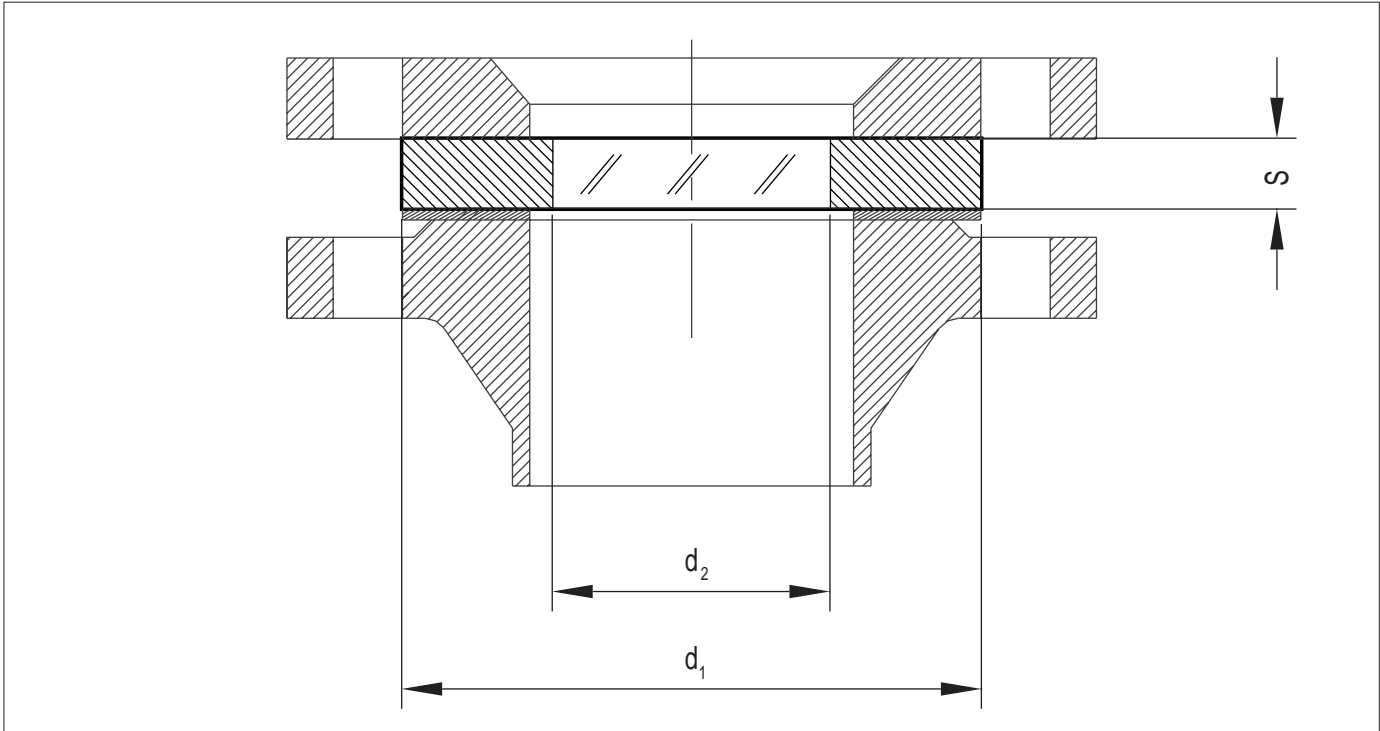

Nominal Bore	16 Bar			40 Bar		
	d1	d2	S	d1	d2	S
25	70	30	10	70	30	15
32	82	40	12	82	40	15
40	92	45	15	92	45	20
50	107	50	15	107	50	20
65	127	70	15	127	70	25
80	142	75	20	142	75	25
100	162	80	20	162	80	25
125	192	100	20	192	100	30
150	218	100	25			
200	273	120	30			

Ordering Information

Please specify your selected items as follows:

Nominal bore, Outside diameter (d1), Viewing diameter (d2)

Pressure

Temperature

Ring Material

08/2001

All dimensions in mm unless otherwise stated

Subject to change without notice