

Lumiglas Stainless Steel Luminaire, Series USL13

DATA SHEET 06.13

For use with sight glass fittings

This super-compact sight port luminaire is applicable for combination view/sight port (single flange version) or separate light and sight port (dual-flange version).

This powerful super-compact size luminaire is designed to give glare-free illumination with sight glass styles as follows:

DIN 28 120, DIN 28121 or similar circular flanges, Visual Flow Indicators, as well as weld-neck style series MV to DIN 11851.

Nominal sizes depending on fixture type:

- a) Circular weld-on sight glass series DIN 28 120 starting at DN 25...
- b) Circular sight glass series DIN 28120 starting at DN 40...
- c) Visual Flow Indicators
- d) Circular weld-neck series MV similar DIN 11851 starting at DN 50...

Application:

Optimum for the illumination of bio-reactors, laboratory mixers, filters, boilers, tanks, agitators, separators, pipes and other sealed vessels in locations that are not potentially explosive.

Excellent application in the pharmaceutical and food industry.

Protection:

Dust and waterjet tight to IP 65 per EN 60 529/DIN VDE 0470, Part 1 and NEMA Types 4 & 4X.

Operating conditions:

Independent of the pressure/ vacuum inside the vessel;
Maximum allowable ambient temperature at the cable gland 90° C.

Under no circumstances must the Lumiglas lamp be used for sealing purposes in a vessel port in lieu of a sight port.

Electrical information:

The Lumiglas lamp comes equipped with a 3 meter connecting cable.

Operating Voltage:

Without built-in push-button:

12 V, 24 V, 120 V... Halogen incandescent lamp, 20 W
2-pin socket G4

With built-in push-button:

12 V, 24 V, 120 V... Halogen incandescent lamp, 50 W
2-pin socket GY4 6.35

Transformers:

Transformers for 12 V or 24 V secondary voltage available upon request.

Momentary push-button:

Momentary switches or timers are required for 50-Watt luminaires. 50-Watt luminaires should be operated only in momentary mode!

Mounting bracket:

The mounting bracket for the lamp (pivoting hinge) is included. Adapter flange for mounting series MV weld-neck type sight port can be ordered separately.



Stainless steel Lumiglas Luminaire USL13



Stainless steel Lumiglas luminaire series USL13 with hinged bracket mounted onto a circular sight glass fitting series DIN 28 120

Dimensions for Lumiglas Luminaire Stainless Steel Series USL13

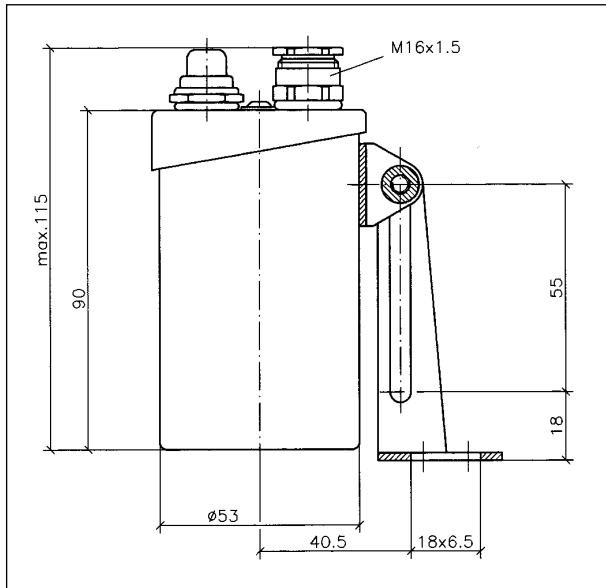

Parts, Construction and Materials:

- Body and Cover: stainless steel 1.4301.
- Fastenings: 1.4301 (Hinged bracket or Adapter Flange).
- Power Cable: 3 meters (3 x 0,75 mm²).
- Weight: 0,58 kg.

Connection Data (all USL13 Luminaires are not furnished with built-in transformer)

Stainless Steel Lumiglas Luminaire USL13					Replacement Parts		
Item	Series USL13	Push Button	Part No.	Supply Voltage	Socket	Halogen Lamp Voltage/Power	Part No. ¹⁾
1	(12 V) 20 W	yes	3540.206.00	12	GY6.35	12 V/20 W	3232.240.00
2	(12 V) 20 W	-	3540.207.00	12	GY6.35	12 V/20 W	3232.240.00
3	(24 V) 20 W	yes	3540.208.00	24	G4	24 V/20 W	3232.206.00
4	(24 V) 20 W	-	3540.209.00	24	G4	24 V/20 W	3232.206.00
5	(120 V) 20 W	yes	3540.210.00	120	GY6.35	120 V/20 W	3232.267.00
6	(120 V) 20 W	-	3540.211.00	120	GY6.35	120 V/20 W	3232.267.00
7							
8	(12 V) 50 W	yes	3540.215.00	12	GY6.35	12 V/50 W	3232.238.00
9	(24 V) 50 W	-	3540.217.00	24	GY6.35	24 V/50 W	3232.242.00
10	(120 V) 50 W	yes	3540.219.00	120	GY6.35	120 V/50 W	3232.265.00
11	(120 V) 50 W	-	3540.220.00	120	GY6.35	120 V/50 W	3232.265.00

¹⁾ = Ordering No.

Luminaire Mounting:

- Hinged Bracket Part No. 0527.008.00 (included)
 Adapter Flange DN 50 Series MV Part No. 1356.027.00 (separate order)
 Adapter Flange DN 65 Series MV Part No. 1356.007.00 (separate order)

Ordering information:

e.g. Lumiglas Luminaire Stainless Steel type USL13, 24 V/20 W with push button, part No. 3540.208.00 and additionally on demand:
 Luminaire mounting „Adapter Flange“ DN 65, part No. 1356.007.00.

Application Examples:



Installed as lighting port assembly, using hinged bracket, fitted to circular sightglass port to DIN 28120 DN 50



Installed on a Series MV DN 65 using Adapter Flange

RD 2000/03.01 3755.199

All dimensions in mm unless stated otherwise. Subject to change without prior notice.